

Loft Insulation

What to Expect?

■ What is Loft Insulation – LI?

Loft insulation is the barrier of material, usually mineral fibre wool, in your roof spaces that traps heat. It keeps your house warm in the winter and cool in the summer.

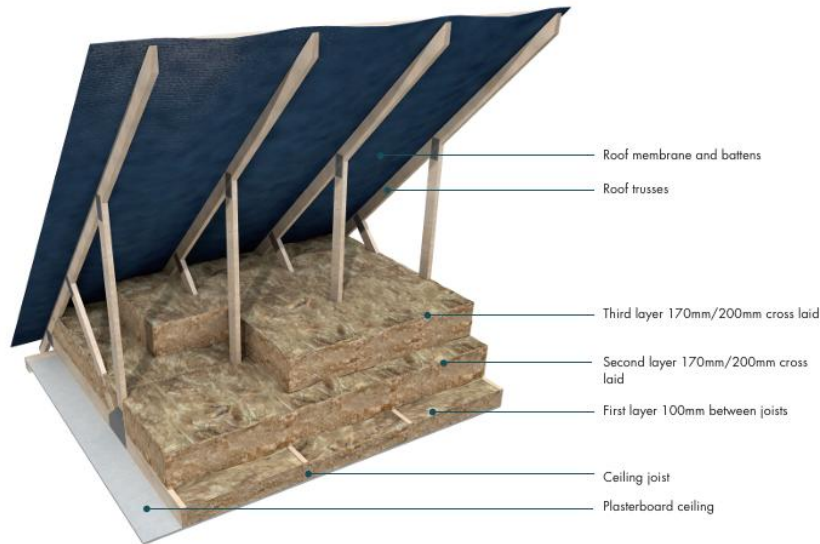

■ What materials are used?

The typical tools and materials you will see during a loft installation are:

- Rolls of mineral fibre wool insulation wrapped in recyclable packaging
- Sealant
- Tape
- Crawl boards
- Staple guns
- Knives
- PPE

■ Why am I having this done?

We are working with your housing association to support their decarbonisation goals. This means updating homes with more energy-efficient products. This process is called Retrofit.

■ What are the benefits of LI?

Loft insulation will lower your heating bills and improve your home's energy efficiency rating.

Is it quite disruptive?

The works required clear access to the loft hatch as additional insulation material is installed in the loft space. Please note that loft spaces at English Rural should not be used for storage. Ensure the loft area is fully cleared of all belongings ahead of the installation date.

What is the installation process?

■ Step 1 – Assessment

Your property will have undergone a retrofit assessment. This allows the team to come and see your property so they can design your specific loft insulation. These will be shown to you before work starts.

■ Step 2 – Installation booked

An installation date will be agreed upon at your convenience.



■ Step 3 – On the day

The loft will need to be cleared of **all** items and the installer will prep the area by looking out for electrical or TV cabling, water piping, ventilation provisions and other features that may need to be considered before installation starts.

Airtightness measures will then be made, sealing off any gaps where air could leak into the roof space using a high-quality sealant and/or tape.

Our installers will be fully kitted out in full PPE at this stage. Starting at the eaves, the rolls of required insulation will then be opened and laid out. One – two layers may be used during the install. We will then insulate the loft hatch.

Once completed, the loft should be fully covered in a consistent depth of insulation with all gaps filled.

How do I care for my LI?

Once the loft installation is installed it will require minimal maintenance.

Insulation is most effective when it remains dry. If you notice any signs of damp or mould in your loft, contact us immediately. Moisture can compromise the insulation and lead to long-term damage.

Storage: Please note that loft spaces at English Rural should not be used for storage.

Good ventilation is key to maintaining the effectiveness of your loft insulation. Ensure that your loft vents are not blocked by insulation or other items allowing proper airflow.

■ Handover Pack

You will be given a full product specification guide upon completion, showing how to use and maintain your new energy-efficient products, and contact details if you have any issues.